

NOTES



REGIONAL ANAESTHESIA



SPINAL NEEDLES

NEEDLES FOR SPINAL ANAESTHESIA /
LUMBAR PUNCTURE**Hub**

- transparent to visualise CSF reflux
- ergonomic design to ensure easy handling and manipulation.

Stylet

- with lug to indicate the position of the distal eye (Whitacre needle) or bevel orientation (Quincke needle)
- specially designed to allow rapid reflux of CSF
- ISO standard colour coding
- can be easily repositioned in the needle, if dural puncture fails.

Needle

- thin walled to obtain rapid CSF reflux.

Extensive range

- ▶ Large range of needle lengths and diameters for spinal anaesthesia and lumbar puncture
- ▶ Short needles for paediatrics
- ▶ Extra-long needles for obese patients and combined epidural-spinal anaesthesia (from 120 to 185 mm)
- ▶ Two bevels: Whitacre or Quincke type.

**181/5181 "Whitacre" pencil point spinal needle**

- The "pencil point" bevel minimises damage to the dura mater and CSF leakage
- Eye close to the distal tip to minimise the risk of extra-dural injection of the anaesthetic
- Smoothed lateral eye.

Code	Needle				Introducer		Distal specifications		Box /case
	G	Length mm	Ext. Ø mm	colour coding	Length mm	Ext. Ø mm	<- X -> mm	<- Y -> mm	
181.03	29	90	0.35	●	38	0.7	0.60	0.60	20/800
5181.23	29	120	0.35	●	No introducer		0.60	0.60	20/480
181.04	27	90	0.42	●	38	0.7	0.70	0.70	20/800
5181.24	27	120	0.42	●	No introducer		0.70	0.70	20/480
181.34	27	135	0.42	●	38	0.7	0.70	0.70	20/180
181.44	27	145	0.42	●	38	0.7	0.70	0.70	20/180
181.94	26	90	0.47	●	38	0.9	0.70	0.70	20/800
5181.94	26	90	0.47	●	No introducer		0.70	0.70	20/800
5181.45	25	38	0.53	●	No introducer		0.90	0.90	20/800
181.75	25	75	0.53	●	38	0.9	0.90	0.90	20/800
181.05	25	90	0.53	●	38	0.9	0.90	0.90	20/800
5181.05	25	90	0.53	●	No introducer		0.90	0.90	20/800
181.25	25	120	0.53	●	38	0.9	0.90	0.90	20/480
181.45	25	145	0.53	●	38	0.9	0.90	0.90	20/180
5181.185	25	185	0.53	●	No introducer		0.90	0.90	10/180
181.95	24	90	0.55	●	38	0.9	0.90	0.90	20/800
181.07	22	90	0.72	●	No introducer		1.20	1.20	20/800
5181.27	22	120	0.72	●	No introducer		1.20	1.20	20/480

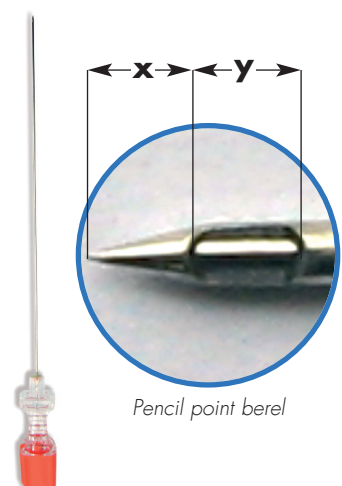

Pencil point bevel

Code 181

179
20/1920**Introducer for spinal needles**

Code	Diameter		Length mm
	mm	G	
179.49	1.2	18	38
179.45	0.9	20	38

SPINAL NEEDLES

180/5180 Spinal needle with "Quincke" bevel
20/800

In addition to the benefits described on page 118, needles with Quincke bevel have a stylet which has been specially designed to reduce tissue trauma and consequently post-dural puncture headaches.

Code	Needle				Introducer	
	G	Length mm	Ext. Ø mm	Colour coding	Length mm	Ext. Ø mm
180.93	29	90	0.35	●	38	0.7
180.04	27	90	0.42	●	38	0.7
5180.04	27	90	0.42	●	No introducer	
180.74	26	75	0.47	●	38	0.9
180.94	26	90	0.47	●	38	0.9
5180.94	26	90	0.47	●	No introducer	
5180.35	25	30	0.53	●	No introducer	
180.55	25	50	0.53	●	No introducer	
180.75	25	75	0.53	●	38	0.9
5180.75	25	75	0.53	●	No introducer	
180.05	25	90	0.53	●	38	0.9
5180.05	25	90	0.53	●	No introducer	
5180.76	23	75	0.60	●	No introducer	

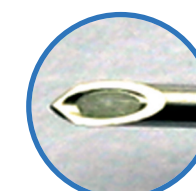
Quincke
type bevel

Code 180

183 Quincke needle for lumbar puncture
5180/5183
20/800

Code	Needle			
	G	Length mm	Ext. Ø mm	Colour coding
183.47	22	38	0.7	●
5183.57	22	50	0.7	●
5183.77	22	75	0.7	●
183.97	22	90	0.7	●
5180.27*	22	120	0.7	●
5180.07*	22	150	0.7	●
183.49	20	38	0.9	●
5183.59	20	50	0.9	●
5180.79	20	75	0.9	●
183.99	20	90	0.9	●
5183.51	19	50	1.1	●
5183.71	19	75	1.1	●
183.91	19	90	1.1	●
5183.52	18	50	1.2	●
5183.72	18	75	1.2	●
183.92	18	90	1.2	●

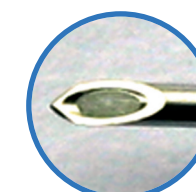
Quincke
type bevel

Code 183

* N.B. Codes 5180.07 and 27,
quantity box/case : 20/180

188.07 Needle and catheter for intra-thecal anaesthesia
20/240

The intra-thecal catheter allows:

- Injections of small doses of local anaesthetic, thereby limiting haemodynamic variations
- Re-injection of anaesthetic to increase the duration of the block
- Post-operative analgesia.

Presented in a soft blister pack containing:

- 1 polyurethane catheter with XRO line, (Ø 0.3 x 0.7 mm - 22G - Length 90 cm) with catheter guide, open tip, centimetre graduations from 5 to 20 cm
- 1 19G Tuohy needle with transparent hub and detachable wings - Length 90 mm.

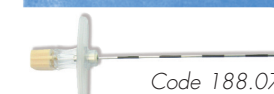

Code 188.07



EPIDURAL ANAESTHESIA

EPIDURAL NEEDLES

184 Tuohy needle for epidural anaesthesia

Stylet

- with lug to indicate bevel orientation
- stainless steel

Needle

- the heel of the bevel is smoothed to reduce the risk of cutting the epidural catheter
- needle/stylet fit together perfectly to give a completely smooth bevel surface and minimize coring of the skin and subcutaneous tissues
- centimetre graduations
- extra-long needles available for obese patients

Hub

- transparent to visualise any fluid reflux
- with removable wings for easier insertion

Code	Needle				Box / case
	G	Length mm	Int. Ø - Ext. Ø mm	Colour coding	
184.19	19	90	0.8 - 1.08	Orange	20/800
184.88	18	80	1.07 - 1.30	Pink	20/800
184.18	18	90	1.12 - 1.32	Pink	20/800
184.28	18	120	1.12 - 1.32	Pink	20/180
184.58	18	150	1.12 - 1.32	Pink	20/180
184.17	17	90	1.2 - 1.5	White	20/800
184.27	17	120	1.2 - 1.5	White	20/480
184.87	17	80	1.2 - 1.5	White	20/800
184.86	16	80	1.35 - 1.65	Blue	20/800
184.16	16	90	1.35 - 1.65	Blue	20/800

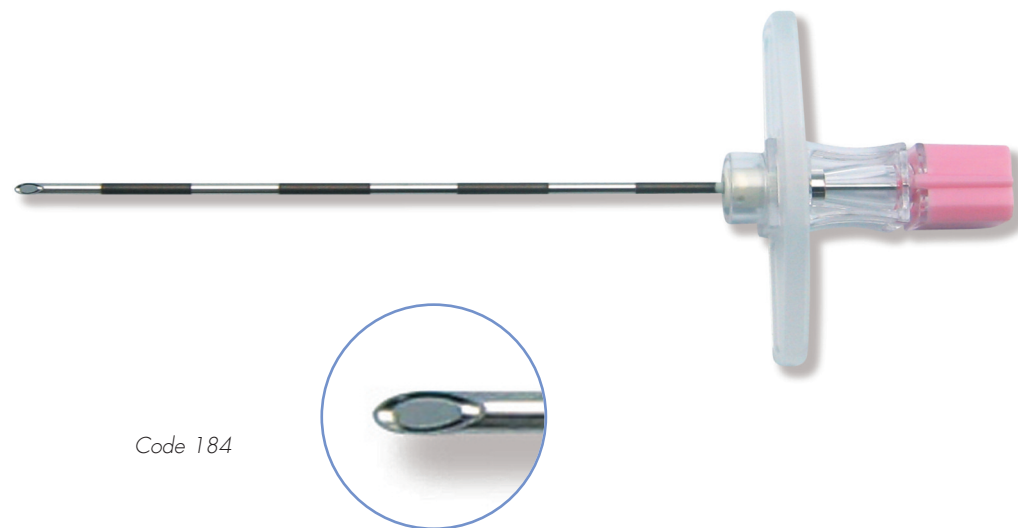

Code 184



EPIDURAL ANAESTHESIA PERIBAX RANGE

PERIBAX : PERBAX EPIDURAL CATHETERS

- Material is an excellent compromise between **flexibility and rigidity**, allowing easy insertion of catheter while limiting risk of trauma
- Excellent **rupture resistance** due to high stretch potential, making it very safe to use
- Transparent with radiopaque line
- Supplied with a catheter-guide which connects onto the needle hub and facilitates insertion of the catheter into the needle and epidural space
- With removable "Easy-lock" type adaptor
- Markings:
 - . centimetre graduations from 5 to 20 cm from the distal tip
 - . black mark on the distal end to ensure that the entire catheter has been withdrawn
- Smoothed distal end.

5186 PERIBAX : epidural catheter (for 18G introducer)

20/240

Code	Int. Ø - Ext. Ø mm	G	Length cm	Tip
5186.082	0.45 - 0.85	20	90	Open
5186.382	0.45 - 0.85	20	90	Closed with 3 lateral eyes

5186 PERIBAX : epidural catheter (for 16 or 17G introducer)

20/240

Code	Int. Ø - Ext. Ø mm	G	Length cm	Tip
5186.602	0.5 - 1.0	19	90	Open
5186.802	0.5 - 1.0	19	90	Closed with 3 lateral eyes

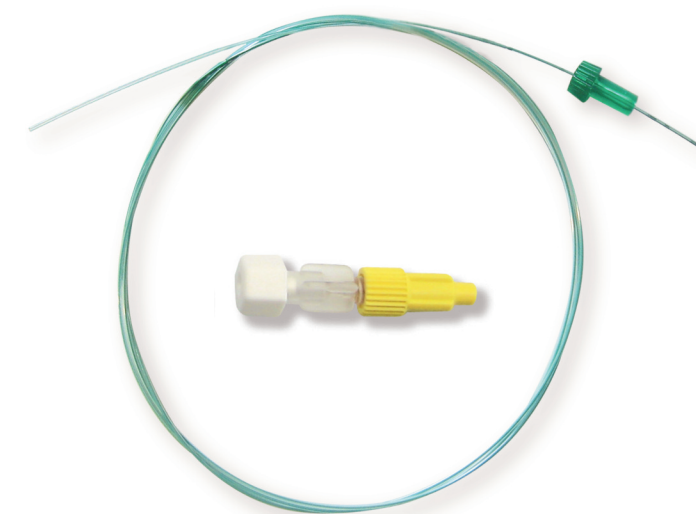

EPIDURAL ANAESTHESIA PERIBAX RANGE

WITH 18G TUOHY NEEDLE

5191 Epidural set with PERIBAX catheter 20/120

Set containing:

- 1 XRO epidural catheter with Easy-lock connector and catheter-guide (code 5191.337 with **flexible distal tip*** and 3 lateral eyes)
- 1 18G Tuohy needle with transparent plastic hub
- 1 0.22µm flat filter
- 1 10 ml syringe for loss of resistance technique.

Code	Tuohy needle		Catheter			
	G	Length mm	Int. Ø - Ext. Ø	G	Length cm	Tip
5191.087	18	80	0.45 - 0.85	20	90	Open
5191.387	18	80	0.45 - 0.85	20	90	Closed with 3 lateral eyes
5191.337	18	80	0.45 - 0.85	20	90	Closed with 3 lateral eyes*
5191.088	18	90	0.45 - 0.85	20	90	Open
5191.388	18	90	0.45 - 0.85	20	90	Closed with 3 lateral eyes

* Flexible distal tip

5291.337 Epidural set with PERIBAX catheter 10/120 and Epimatic syringe

Set containing:

- 1 XRO epidural catheter (Int. Ø 0.45 mm - Ext. Ø 0.85 mm - 20G - Length 90 cm) with Easy-lock connector and catheter-guide. **Flexible distal tip** and 3 lateral eyes
- 1 18G Tuohy needle with transparent plastic hub, length 80 mm
- 1 0.22µm flat filter
- 1 Epimatic syringe (see p. 127).

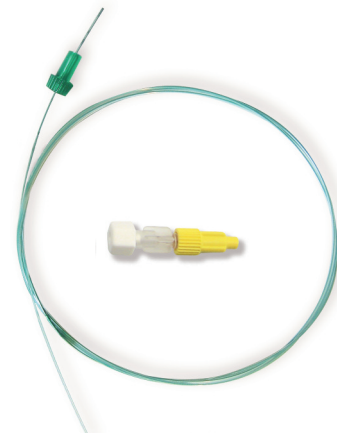

New



WITH 16G TUOHY NEEDLE

5191 Epidural set with PERIBAX catheter 20/120

Set containing:

- 1 XRO epidural catheter with Easy-lock connector and catheter-guide
- 1 16G Tuohy needle with transparent plastic hub
- 1 0.22 µm flat filter
- 1 10 ml syringe for loss of resistance technique.

Code	Catheter				Tuohy Needle	
	Int. Ø - Ext. Ø mm	G	Length cm	Tip	G	Length mm
5191.601	0.5 - 1.0	19	90	Open	16	80
5191.801	0.5 - 1.0	19	90	Closed with 3 lateral eyes	16	80

EPIDURAL ANAESTHESIA PERIPUR RANGE

PERIPUR : POLYURETHANE EPIDURAL CATHETERS

- **Flexible** catheters without stylet
- Transparent with radiopaque line
- With a catheter-guide which connects onto the needle hub and facilitates insertion of the catheter into the needle and epidural space
- With detachable "Easy-lock" type adaptor
- Markings:
 - . Centimetre graduations from 5 to 15 cm and mark at 20 cm from the distal tip
 - . Black mark on the distal tip allowing the user to check that the entire catheter has been withdrawn
- Rounded distal tip
- Resistant to kinking and stretching.

EPIDURAL RANGE WITH PERIPUR CATHETER

186.10 PERIPUR : epidural catheter 20/240

Catheter (PUR - XRO) with **open tip**.

Int. Ø - Ext. Ø mm	G	Length cm	Recommended introducer needle
0.5 - 1.0	19	90	17G

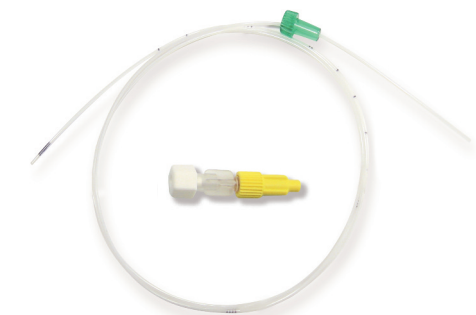

188.10 Set (PERIPUR catheter + needle) 20/240

Basic kit containing one catheter code 186.10, described above and one 17G Tuohy needle with metal hub.

189.60 Mini-kit (PERIPUR catheter + needle + filter) 20/240

Mini-kit containing one catheter code 186.10, one 17G Tuohy needle with plastic hub (code 184.17) and one flat 0.22 µm filter (code 808.22).

191.10 Kit (PERIPUR catheter + needle + filter + needle) 20/120

Kit includes one 10 ml syringe for loss of resistance technique (code 1018.10) in addition to items in mini-kit code 189.60

Kit for paediatric epidural anaesthesia code 188.47:
see page 31



EPIDURAL ANAESTHESIA PERIPUR RANGE

186.30 PERIPUR: epidural catheter 20/240

Catheter (PUR – XRO) with closed tip, 3 lateral eyes.

Int. Ø - Ext. Ø mm	G	Length cm	Recommended introducer
0.5 - 1.0	19	90	17G



188.30 Set (PERIPUR catheter + needle) 20/240

Basic kit containing one catheter code 186.30, described above, and one 17G Tuohy needle with metal hub.

189.30 Mini-kit (PERIPUR catheter + needle + filter) 20/240

Mini-kit containing one catheter code 186.30, one 17G Tuohy needle with plastic hub and one flat 0.22 µm filter (code 808.22).

191.30 Kit (PERIPUR catheter + needle + filter + syringe) 20/120

Kit includes one 10 ml syringe for loss of resistance technique (code 1018.10) in addition to items in mini-kit code 189.30.

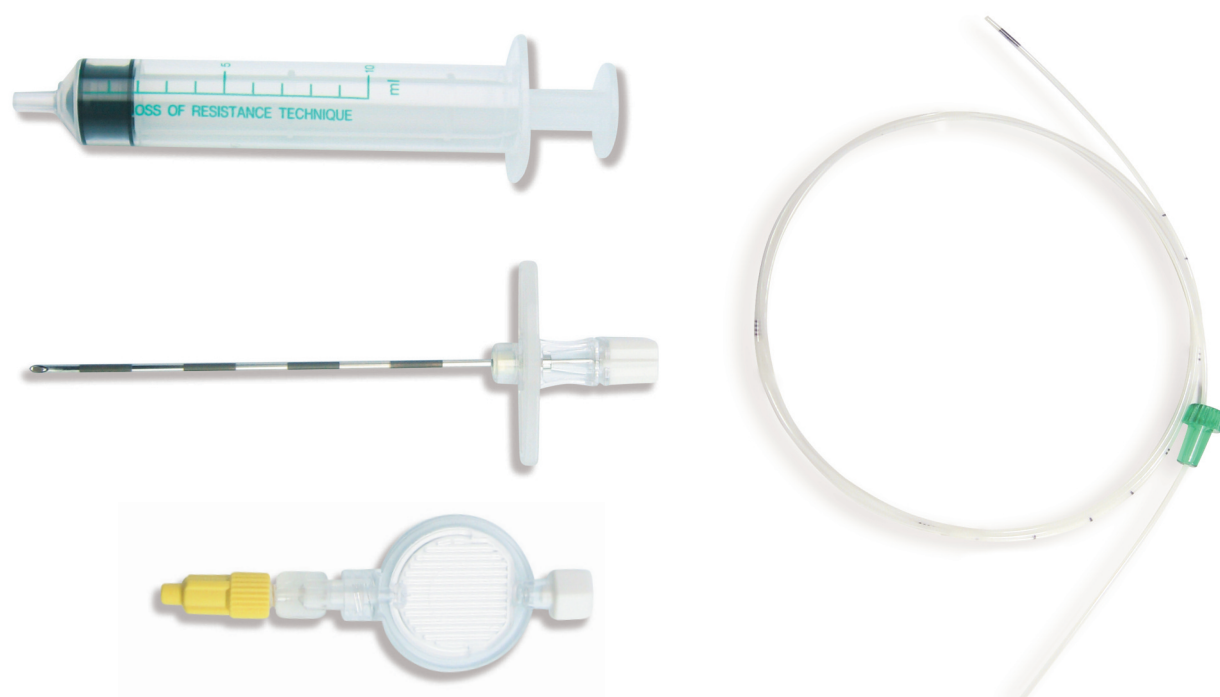

EPIDURAL ANAESTHESIA PERISTYL' RANGE

PERISTYL': FLEXIBLE EPIDURAL CATHETER WITH STYLET

- **Flexible** transparent polyethylene epidural catheter **with stylet**. The flexibility of the catheter reduces the risk of dural or vascular puncture
- The stylet allows easy insertion of the catheter. The stylet stops 17 mm from the distal tip of the catheter (no risk of entering the epidural space)
- With Easy-lock connector
- Smooth distal tip
- Transparent catheter with radiopaque line.

EPIDURAL RANGE WITH PERISTYL' CATHETER

185 PERISTYL' : epidural catheter 20/240

Flexible transparent polyethylene epidural catheter with stylet. Tip either open (code 185.10) or closed with 3 lateral eyes (code 185.30). Centimetre graduations from 5 to 20 cm (code 185.30).

Code	Int. Ø - Ext. Ø mm	G	Length cm	Tip	Recommended introducer
185.10	0.5 - 1.0	19	90	Open	17G
185.30	0.5 - 1.0	19	90	Closed with 3 lateral eyes	17G

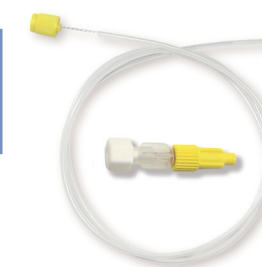

187.10 Set (PERISTYL' catheter + needle) 20/240

Basic kit containing one catheter code 185.10, described above and one 17G Tuohy needle with metal hub.

189.50 Mini-kit (PERISTYL' catheter + needle + filter) 20/240

Mini-kit containing one catheter code 185.10, one 17G Tuohy needle with plastic hub (code 184.17) and one flat 0.22 µm filter (code 808.22).

191.50 Kit (PERISTYL' catheter + needle + filter + syringe) 20/120

Kit includes one 10 ml syringe for loss of resistance technique (code 1018.10) in addition to items in mini-kit code 189.50.

191.70 Kit (PERISTYL' catheter + needle + filter + syringe) 20/120

Kit includes the same components as code 191.50 described above, but with PERISTYL' catheter code 185.30: **closed tip with 3 lateral eyes**.



Code 191.50

ACCESSORIES FOR EPIDURAL ANAESTHESIA

193.00 Balloon for identification of the epidural space

25/300

(Macintosh method).

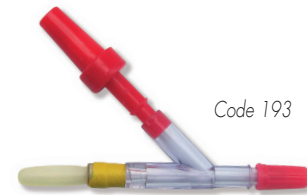

Code 193

808.22 Flat filter for epidural anaesthesia

25/600

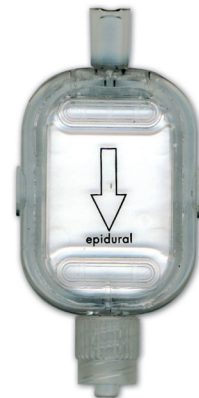

Code 808.22

809.22 Filter

50/1000

0.22 µm (anti-bacterial) filters for retaining microbial particles and contaminants contained in solutions. Luer-lock fittings. Code 809.22 is radiosterilized.

Code	Total filter surface area cm ²	Flow rate ml/min	Priming volume ml	Pressure resistance
808.22	5.0	28	1.2	6 bar (600 kPa)
809.22*	2.8	5	0.1	5 bar (500 kPa)

*Flow rate under pressure 3.6 bar = 145 ml/min

Code 809.22



7303.17 Tunnelling needle for epidural catheter

5/75

Length 35 cm – Diameter 1.7 x 2.2 mm.



41.08.07/ Drapes for epidural anaesthesia

39.80.14

Code	Size cm	Adhesive opening cm	Adhesive edge cm	Quality	Box/case
41.08.07	70 x 80	7 x 12	5 x 70	Impermeable material with absorbent surface	50
39.80.14	80 x 140	5.5 x 7.5	-	Transparent polyethylene	10/80

SYRINGES FOR LOSS OF RESISTANCE TECHNIQUE

1018 Plastic syringe for loss of resistance technique

20/240

7 ml (code 1018.07) or 10 ml (code 1018.10) polypropylene syringe with Luer slip fitting. Code 1018.103: 10 ml polypropylene syringe with Luer-lock fitting. This item does not contain latex.

Code	Volume ml	Tip
1018.07	7	Luer
1018.10	10	Luer
1018.103	10	Luer-lock



Code 1018.10

1018.102 Epimatic: Plastic syringe for loss of resistance technique

20/240

Epimatic is a syringe allowing automatic location of the epidural space thanks to the continuous positive pressure applied on the plunger by an elastic strip.

Product benefits:

- Inserting the needle with 2 hands ensures its smooth progression
- Visual confirmation of access of Tuohy needle to the epidural space
- Syringe can be used either with liquid* or air*

* If the syringe is filled with gas, clip the device with the letter "G" or the symbol "+" toward the top of the syringe (toward the anaesthetist).

If the syringe is filled with liquid, clip the device with the letter "L" or the symbol "+" toward the anaesthetist.

New

Brochure



Epimatic syringe

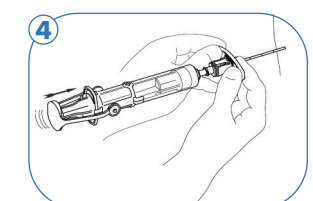
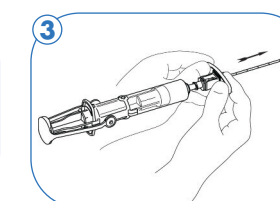
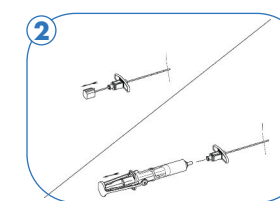
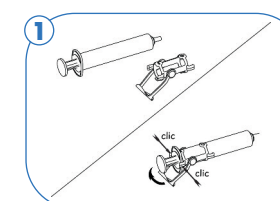
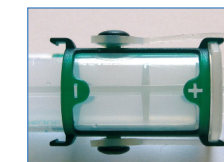

- 1 Choice of the syringe filling (gas/ liquid). Insert and clip the device. Place the elastic strip on the plunger.
- 2 Remove the stylet from the Tuohy needle which is already placed in the patient's back. Fill the syringe with air or liquid by pulling together strip/plunger.
- 3 Hold the plunger and connect the syringe to the needle.
- 4 Move slowly until the epidural space is reached and the plunger drops or the air/ liquid is easily injected.

1019.10 Glass syringe for loss of resistance technique

With Luer-lock fitting. Volume 10 ml.



EPIDURAL RANGE

Summary table

Code	Recommended introducer	Epidural catheter			
	G	G	Int. Ø - Ext. Ø	Material	Tip
185.10	17	19	0.5 - 1.0	PE (with stylet)	open
185.30	17	19	0.5 - 1.0	PE (with stylet)	closed*
186.10	17	19	0.5 - 1.0	PUR	open
186.30	17	19	0.5 - 1.0	PUR	closed*
5186.082	18	20	0.45 - 0.85	PEBAX	open
5186.382	18	20	0.45 - 0.85	PEBAX	closed*
5186.602	16 or 17	19	0.5 - 1.0	PEBAX	open
5186.802	16 or 17	19	0.5 - 1.0	PEBAX	closed*

*with 3 lateral eyes.

Code	Epidural catheter				Accessories				
	G	Int. Ø - Ext. Ø mm	Material	Tip	Epidural needle			Filter	Syringe
					G	L. mm	Hub		
187.10	19	0.5 - 1.0	PE (with stylet)	open	17	90	metal	-	-
189.50	19	0.5 - 1.0	PE (with stylet)	open	17	90	plastic	X	-
191.50	19	0.5 - 1.0	PE (with stylet)	open	17	90	plastic	X	X
188.10	19	0.5 - 1.0	PUR	open	17	90	metal	-	-
189.60	19	0.5 - 1.0	PUR	open	17	90	plastic	X	-
191.10	19	0.5 - 1.0	PUR	open	17	90	plastic	X	X
188.30	19	0.5 - 1.0	PUR	closed*	17	90	metal	-	-
189.30	19	0.5 - 1.0	PUR	closed*	17	90	plastic	X	-
191.30	19	0.5 - 1.0	PUR	closed*	18	90	plastic	X	X
5191.087	20	0.45 - 0.85	PEBAX	open	18	80	plastic	X	X
5191.088	20	0.45 - 0.85	PEBAX	open	18	90	plastic	X	X
5191.337**	20	0.45 - 0.85	PEBAX	closed*	18	80	plastic	X	X
5291.337**	20	0.45 - 0.85	PEBAX	closed*	18	80	plastic	X	Epimatic
5191.387	20	0.45 - 0.85	PEBAX	closed*	18	80	plastic	X	X
5191.388	20	0.45 - 0.85	PEBAX	closed*	18	90	plastic	X	X
5191.601	19	0.5 - 1.0	PEBAX	open	16	80	plastic	X	X
5191.801	19	0.5 - 1.0	PEBAX	closed*	16	80	plastic	X	X

* with 3 lateral eyes.

** with flexible distal tip.

COMBINED SPINAL - EPIDURAL
ANAESTHESIA

COMBINED SPINAL - EPIDURAL SETS

192
20/480

Mini-set for combined spinal - epidural anaesthesia

Presented in a supple blister pack containing:

Code 192.201

- 1 spinal needle, Whitacre type 118 mm, 27G
- 1 Tuohy needle with back-eye 18G, 80 mm.

New

Code 192.202

- 1 spinal needle, Whitacre type 118 mm, 25G
- 1 Tuohy needle with back-eye 18G, 80 mm.

N.B. The spinal needle protrudes through the distal end of the Tuohy needle by 15 mm.

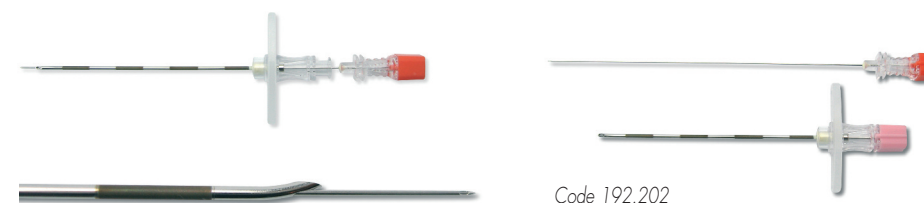

6186 Set for combined spinal - epidural anaesthesia

5/40

Presented in a rigid blister pack containing:

Code 6186.042

- 1 Tuohy needle with back-eye 18G - L. 80 mm
- 1 pencil-point spinal needle 27G - L. 118 mm
- 1 10 ml syringe for loss of resistance technique
- 1 Peribax epidural catheter (Ø 0.45 x 0.85 mm - 20G) with closed tip, 3 lateral eyes and flexible distal end
- 1 flat filter 0.22 µm.

Code 6186.052

- 1 Tuohy needle with back-eye 18G - L. 80 mm
- 1 pencil-point spinal needle 25G - L. 118 mm
- 1 10 ml syringe for loss of resistance technique
- 1 Peribax epidural catheter (Ø 0.45 x 0.85 mm - 20G) with closed tip, 3 lateral eyes and flexible distal end
- 1 flat filter 0.22 µm.

N.B. The spinal needle protrudes through the distal end of the Tuohy needle by 15 mm.

BASIC SET

199.20 Basic Set

25

This procedure pack contains essential items needed for a number of common procedures including lumbar puncture, spinal anaesthesia, epidural anaesthesia, liver biopsy, etc.

Pack contains:

- 1 tray
- 1 each syringe Luer slip 2.5, 5 and 10 ml
- 1 aperture drape (opening 7 x 12 cm) with adhesive edge 70 x 80 cm
- 1 gallipot
- 1 prep forceps
- 4 ball swabs (small)
- 2 ball swabs (large)
- 1 filter needle 5 µm
- 3 hypodermic needles 25G, 21G and 18G
- 1 outer wrap 75 x 70 cm
- 1 absorbent towel 33 x 38 cm.



Code 199.20

CUSTOM - MADE KITS

Vygon also offers a custom made service ensuring the pack reaches your specific requirements.

Gallipots

White 62 x 72 – 60 ml
Crystal 62 x 72 – 60 ml
Transparent graduated 120 ml

Syringes

2.5 ml Luer slip
3 ml Luer-lock
5 ml Luer slip or Luer-lock
7 ml plastic low resistance syringe
10 ml Luer slip or Luer-lock plastic low resistance syringe
10 ml Luer slip or Luer-lock
10 ml Luer-lock glass syringe
20 ml Luer slip or Luer-lock

Hypodermic needles

18 G, 40 mm
19 G, 50 mm
20 G, 38 mm
21 G, 40 mm
22 G, 25 mm
23 G, 30 mm
25 G, 16 mm
27 G, 12 mm

Accessories

Filter needle
Flat filter
Scalpel (long handle)
Scalpel (short handle)
Sponge – stick (small)
Prep forceps (Kocher type)
Dressing forceps

Gauze dressings/ Ball swabs

Gauze 5 x 8, 8 ply
Gauze 7.5 x 7.5, 8 ply
Gauze 7.5 x 7.5, 12 ply
Gauze 10 x 10, 8 ply
Gauze 10 x 10, 12 ply
Non-woven gauze 7.5 x 7.5, 4 ply
Non-woven gauze 10 x 10, 4 ply
Ball swabs Ø 3 cm
Ball swabs Ø 2.5 cm radiopaque
Ball swabs Ø 3 cm radiopaque

Drapes

Lateral drape 75 x 45 cm, adhesive 5 x 45 cm
Lateral drape 70 x 80 cm, adhesive 5 x 70 cm
Lateral drape 80 x 90 cm, adhesive 5 x 90 cm
Fenestrated drape (PE – transparent) 60 x 60 cm, with centered opening Ø 8 cm and adhesive edge 5 x 60 cm
Fenestrated drape (PE – transparent) 90 x 90 cm, with centered opening Ø 8 cm and adhesive edge 5 x 90 cm
Fenestrated drape 80 x 70 cm, off-center adhesive opening 7 x 12 cm and adhesive edge 5 x 70 cm
Fenestrated drape (PE – transparent) 80 x 100 cm off-center adhesive opening 7 x 12 cm and adhesive edge 5 x 80 cm
Fenestrated drape (PE – transparent) 80 x 140 cm off-center adhesive opening 5.5 x 7.5 cm
Absorbent towel 33 x 38 cm, 60g/m² white
Transparent dressing, Dermafil 15 x 10 cm



It is also possible to include any catheter, any needle or other accessories from the spinal and epidural range from page 118 to page 127.

With your Vygon sales representative's help, you can prepare the ideal kit, get a sample and a price estimate.

PLEXUS AND PERIPHERAL NERVE BLOCKS

5194 Locoplex

20/180

Electro-neuro-stimulation needle for plexus and peripheral nerve blocks.

- Insulated needle with a conducting tip
- **Centimetre graduations** to visualise the length of needle introduced
- Transparent needle hub
- Removable extension tube, length 50 cm. Priming volume: 1 ml
- 60 cm electrical connection cable
- Available in 2 versions: 17° bevel or 30° bevel.

Brochure

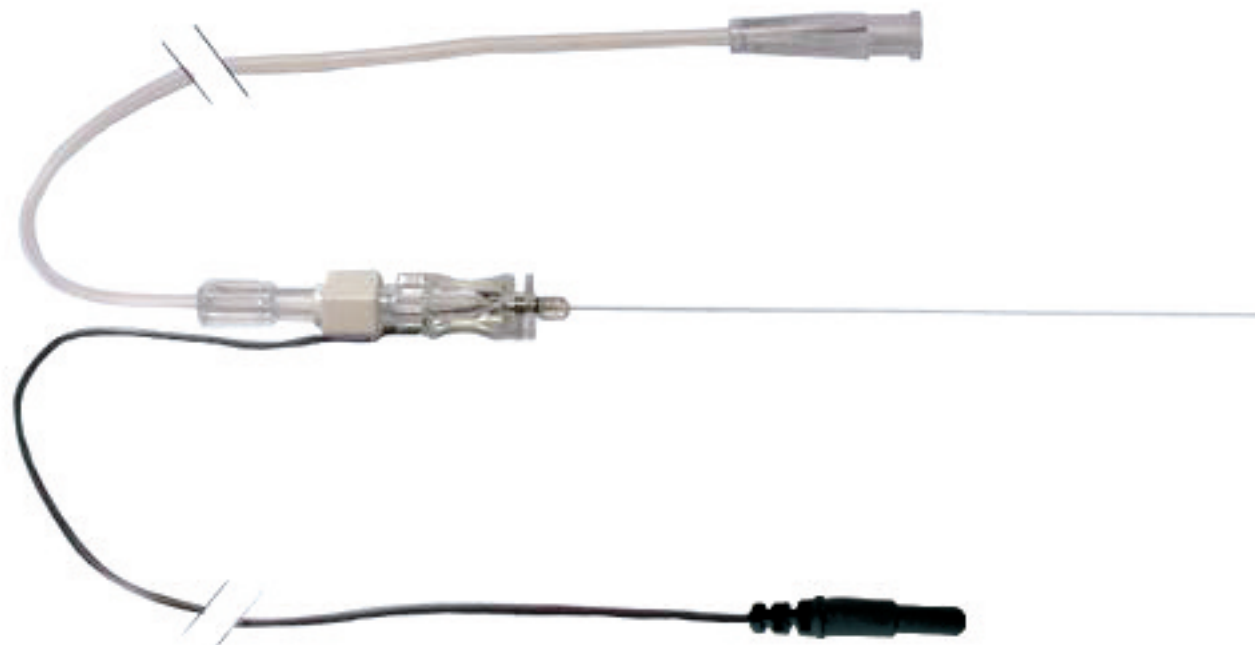

Code		Needle		
Bevel 17°	Bevel 30°	Length mm	Ø mm	G
5194.25	5194.253	25	0.65	23
5194.35	5194.353	35	0.65	23
5194.50	5194.503	50	0.80	21
5194.85	5194.853	85	0.80	21
5194.10	5194.103	100	0.80	21
5194.12	5194.123	120	0.90	20
5194.15	5194.153	150	0.90	20

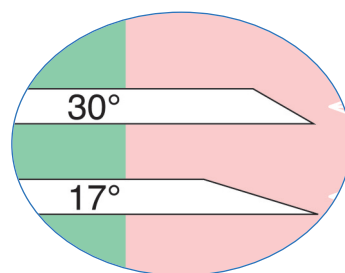

CATHETERS FOR CONTINUOUS NERVE BLOCKS

5195 Techniplex

10/40

Brochure



Perineural catheter for continuous plexus and peripheral nerve blocks.

The Techniplex catheter is introduced through a Locoplex needle with 17° bevel, 30° bevel or Tuohy bevel.

Product benefits:

- The rigidity of the needle provides excellent support for the insertion of the catheter: Techniplex is particularly indicated for blocks involving deeply located nerves
- Centimetre graduations on needle allows quick visualisation of the length of needle introduced
- The wishbone catheter-feeder provides excellent perception of the progression of the catheter through the needle
- All accessories necessary for the insertion of the Techniplex are provided in the set.

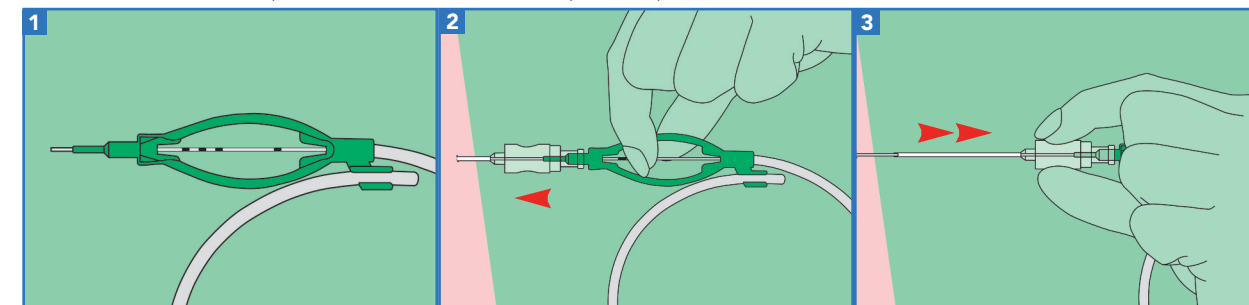

New Techniplex models with stylet to facilitate the insertion of the catheter.

Rigid blister pack presentation containing:

- 1 18G Locoplex needle with centimetre graduations
- 1 perineural Pebax catheter (Ø 0.45 x 0.85 mm – 50 cm long) with centimetre distance markings and open distal tip
- 1 0.22 µm antibacterial filter
- 1 additional extension tube, 50 cm long, Ø 1.5 x 2.5 mm, priming volume 1.10 ml
- 1 10 ml syringe for the aspiration test
- 1 10 x 15 cm Dermafilm transparent adhesive dressing.

Code				Introducer needle		Catheter	
Bevel 17°	Bevel 30°	30° bevel and stylet	Tuohy bevel and stylet	Length mm	G	Int. Ø - Ext. Ø mm	Length cm
5195.35	5195.353	-	-	35	18	0.45 - 0.85	50
5195.50	5195.503	5195.5031*	5195.506*	50	18	0.45 - 0.85	50
5195.10	5195.103	5195.1031*	5195.106*	100	18	0.45 - 0.85	50
5195.12	5195.123	-	-	120	18	0.45 - 0.85	50
-	-	5195.1531*	5195.156*	150	18	0.45 - 0.85	50

*Box/case : 5/45

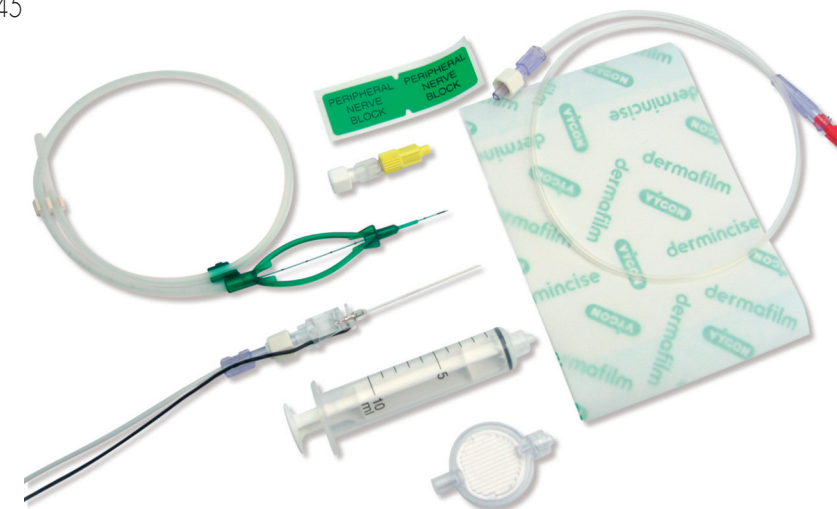

CATHETERS FOR CONTINUOUS NERVE BLOCKS

5197 Multiplex

5/45

Stimulating catheter for continuous plexus and peripheral nerve blocks.

Product benefits:

- Split cannula introducer allows the insertion of a catheter with a fixed hub
- Fixation wings and integral small extension tube
- Metallic stylet
 - Confers rigidity to the catheter facilitating its introduction
 - Allows stimulation during catheter insertion
- All accessories necessary for the placement of the Multiplex are provided in the kit.

Rigid blister pack presentation containing:

- 1 18G split cannula with 30° needle bevel
- 1 catheter with centimetre graduations over 4 cm, once the catheter has been passed through the distal end of the split cannula introducer
- 1 metallic stylet allowing stimulation
- 1 0.22 µm antibacterial filter
- 1 additional electric cable (60 cm long – code 087503.21A) to work under aseptic conditions
- 1 10 ml syringe for aspiration test
- 1 10 x 15 cm Derafilm adhesive transparent dressing.

Code	Split plastic cannula		Needle bevel	Catheter Length mm
	Length mm	G		
5197.353	35	18	30°	92
5197.503	50	18	30°	107
5197.853	85	18	30°	142
5197.123	120	18	30°	177

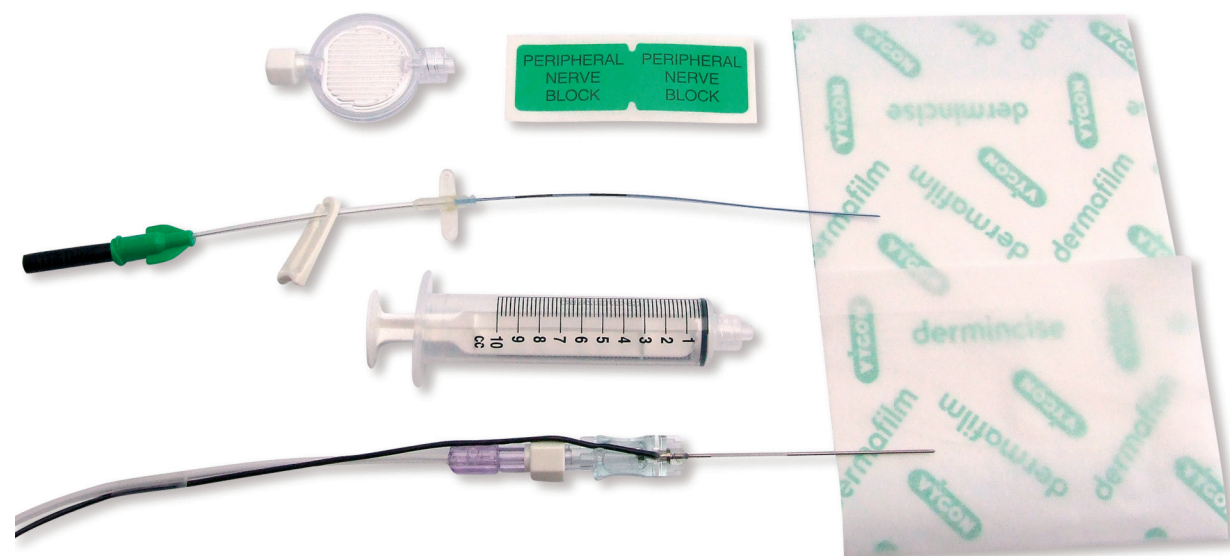
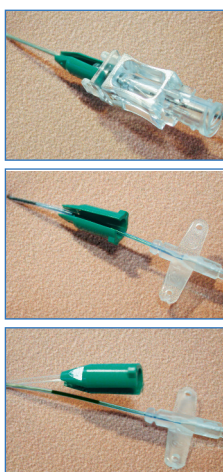

PLEXUS AND PERIPHERAL NERVE BLOCKS / ACCESSORIES

7501.31 Plexygon

1

Electro-neuro-stimulator for plexus and peripheral nerve blocks.

Designed for optimum performance in terms of efficiency, safety and ease of use. Allows quick and easy identification of nerves:

- Large LCD screen
- Adjustable impulse generator:
 - 0 to 4 mA for an impulse of 300 µs
 - 0 to 5 mA for an impulse of 100 µs
 - 0 to 6 mA for an impulse of 50 µs
- Adjustable impulse frequency (1, 2 or 4 Hz) and duration (300 µs, 100 µs or 50 µs)
- Choice of display units: mA or nC
- "Safety" button immediately cuts off the electric current
- Precision: the double decimal digit display is automatically activated below 0.5 mA, by increments of 0.02 mA
- Plexygon can be used under sterile conditions with a protective hood, supplied separately as a single unit (code 39.00.15)
- Dimensions: Length 200 mm / Width: max. 93 mm – min. 57 mm
Height: max. 40 mm – min. 23 mm / Weight: 205 g
- Battery life: over 24 hours continuous operation (battery 9 V – 500 mAh)
- Supplied in a small case for storage and transport
- Conforms to IEC standards 601-1 and 601-2-10.



087503.02A Plexygon replacement cable (red and black)

1

39.00.15 Plexygon transparent protective hood

1

Dimension 12 x 40 cm.

ACCESSORIES

5803.01 Crystalfix

20/480

Fixation device for perineural/epidural catheter.

Ensures excellent fixation of the perineural/epidural catheter preventing the risk of secondary displacement, as secondary migration can result in the anaesthesia or analgesia having no efficacy and generate more or less significant complications (paraesthesia, intravascular injections...)



Simple

Easy to place
A smart shape, can be easily manipulated by left-handed as well as right-handed users



Soft

Flexible and comfortable, it adapts to all areas of the body



Safe

Rounded angles reduce the risk of catheter kinking, transparency at insertion site and a supple material present an ideal compromise between catheter fixation and comfort to the patient.



7301.12 Freedom 5

7301.10

7301.05

1/20

Single-use mechanical device for patient-controlled analgesia

Freedom 5 has been specially designed for pain management in the Accident and Emergency department or in the recovery room for the treatment of post-operative pain. This product is also indicated for pain treatment of patients suffering from sickle cell disease.

It can be easily set-up by healthcare personnel and is extremely simple for the patient to use: if he feels pain, all he has to do is press the lever. Freedom 5 allows the patient to self-administer a pre-set quantity of intravenous morphine solution equivalent to:

- 0.5 ml for model 7301.05. The lock-out for bolus reconstitution is 5 minutes.

- 1 ml for models 7301.12 and 7301.10. The lock-out for bolus reconstitution is 7 minutes.

NB As the bolus reservoir is under negative pressure, downloading is not possible. The pressure that the patient must apply to activate the lever means that an unconscious patient cannot use the PCA device involuntarily. Freedom 5 can be refilled twice using the refilling sets.

The Freedom 5 kit contains:

- 1 PCA reservoir carrier with inspection window
- 1 60 ml calibrated reservoir
- 1 capping device with lever
- 1 attachment cord
- 1 polyethylene storage bag
- 1 female/female Luer-lock adaptor (code 892) for filling the reservoir with a syringe
- 1 female Luer-lock obturator (code 888) for temporary capping of a filled reservoir
- 1 label for the PCA reservoir carrier
- 1 single-lumen extension tube (length 125 cm) with antibacterial and air-eliminating filter and anti-siphon valve: model 7301.10

or

- 1 "Y" extension tube (length 90 cm) with antibacterial and air-eliminating filter and anti-siphon valve (lumen 1) /non-return valve (lumen 2): model 7301.12

or

- 1 single single-lumen extension tube (length 125 cm) with antibacterial and air-eliminating filter and Bionector: model 7301.05

7302.60 Complete refill set

1/18

7302.62

10/60

Presented in a peel-pack containing:

- 1 PCA lockable capping device with lever and cord
- 1 60 ml calibrated reservoir
- 1 female/female Luer-lock adaptor (code 892)
- 1 female Luer-lock obturator (code 888)

Code 7302.60 for PCA 7301.10 or 7301.12

Code 7302.62 for PCA 7301.05.

7302.01 Simplified refill set

7302.02

10/90

Presented in a peel-pack containing:

- 1 PCA lockable capping device with lever
- 1 cord
- 1 female/female Luer-lock adaptor (code 892)

Code 7302.01 for PCA 7301.10 or 7301.12

Code 7302.02 for PCA 7301.05



For PCA extension tubes, see page 103.